

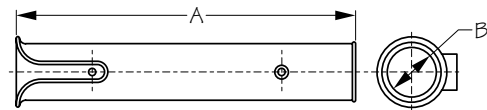

SIDE MOUNT ROD HOLDER

Injection Molded Polypropylene



Made In USA

Bulk Part No.	Display Part No.	A	B	Color	Fast-ener	Weight	Std. Pack
325120	325120-1	11-11/16"	1-3/4"	Black	#10 RH	.22 lb	8 ea
325121	325121-1	11-11/16"	1-3/4"	White	#10 RH	.22	8 ea
325122	325122-1	11-11/16"	1-3/4"	Grey	#10 RH	.22	8 ea

A molded-in stand-off is located on the back of the rod holder allowing direct mounting to any flat surface. Custom colors available on large volume orders.